

RITE-TEMP MFG.

MODEL: RTR-404 Evaporator

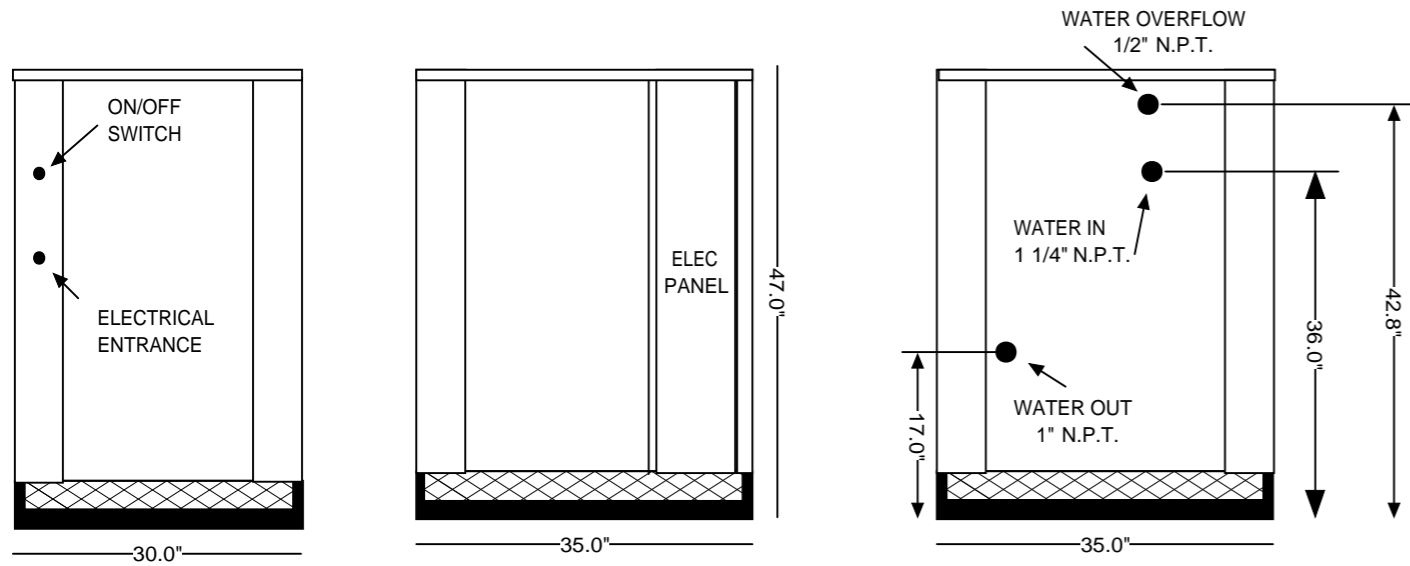

RITE-TEMP MFG.

MODEL: RTR-404 CONDENSER

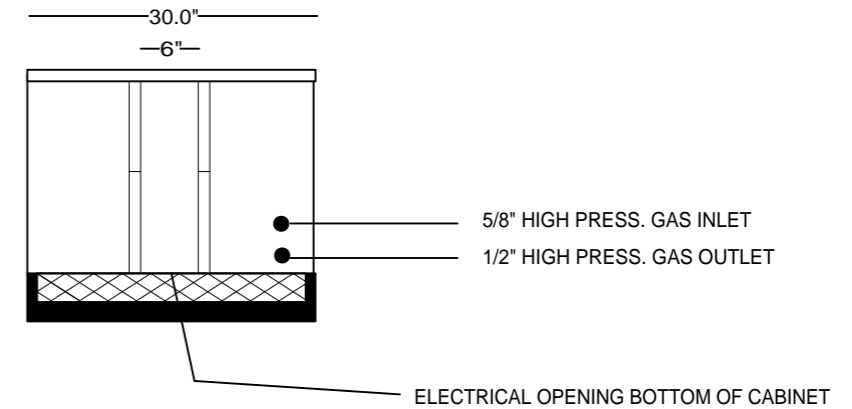

SPECIFICATIONS:

- 48,000 BTU/HR heat removal - 95F degree ambient, 45F degree water out.
- Electrical: 460 / 3Ph., 24 volt electrical panel.
- Run Load 12.2 Amps.
- Minimum Circuit Ampacity: 14; Maximum Circuit Ampacity: 25.
- ETL CSA Laboratory Approved ETL # 63122 & CANSO NO. 236.
- 40 gallon, 16 gage, 304 stainless steel closed evaporator tank with coil inside.
- 1 HP water pump: 25-30 GPM, 30-35 PSI.
- Low ambient start-up package (standard).
- R422D Refrigerant.
- Analog water temperature and pressure gauges.
- Air-cooled condenser.
- Cabinet: 18 and 20 GA Phos coat galvanized steel finished with polyester powder coat.
- Base frame: 1/8 inch angle and channel iron.
- Compressor: Copeland Hermetic (5 year warranty).
- Approximate crated weight: 725 LBS.
- Condenser dimensions: 30" wide X 35" long X 32" tall.
- Evaporator dimensions: 30" wide X 35" long X 47" tall.

