

RITE-TEMP MFG.

MODEL: RTR-603 EVAPORATOR

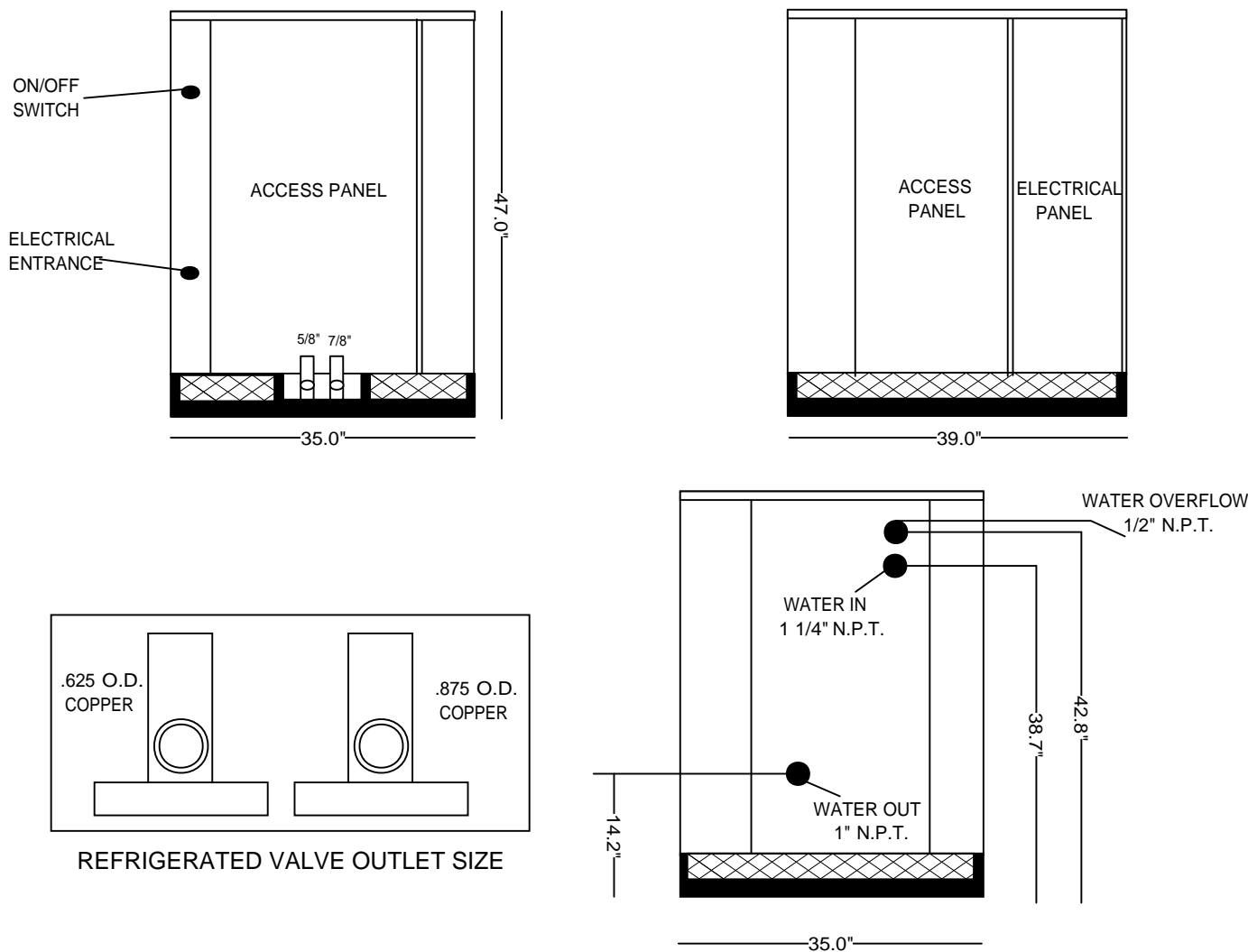

RITE-TEMP MFG.

MODEL: RTR-603 CONDENSER

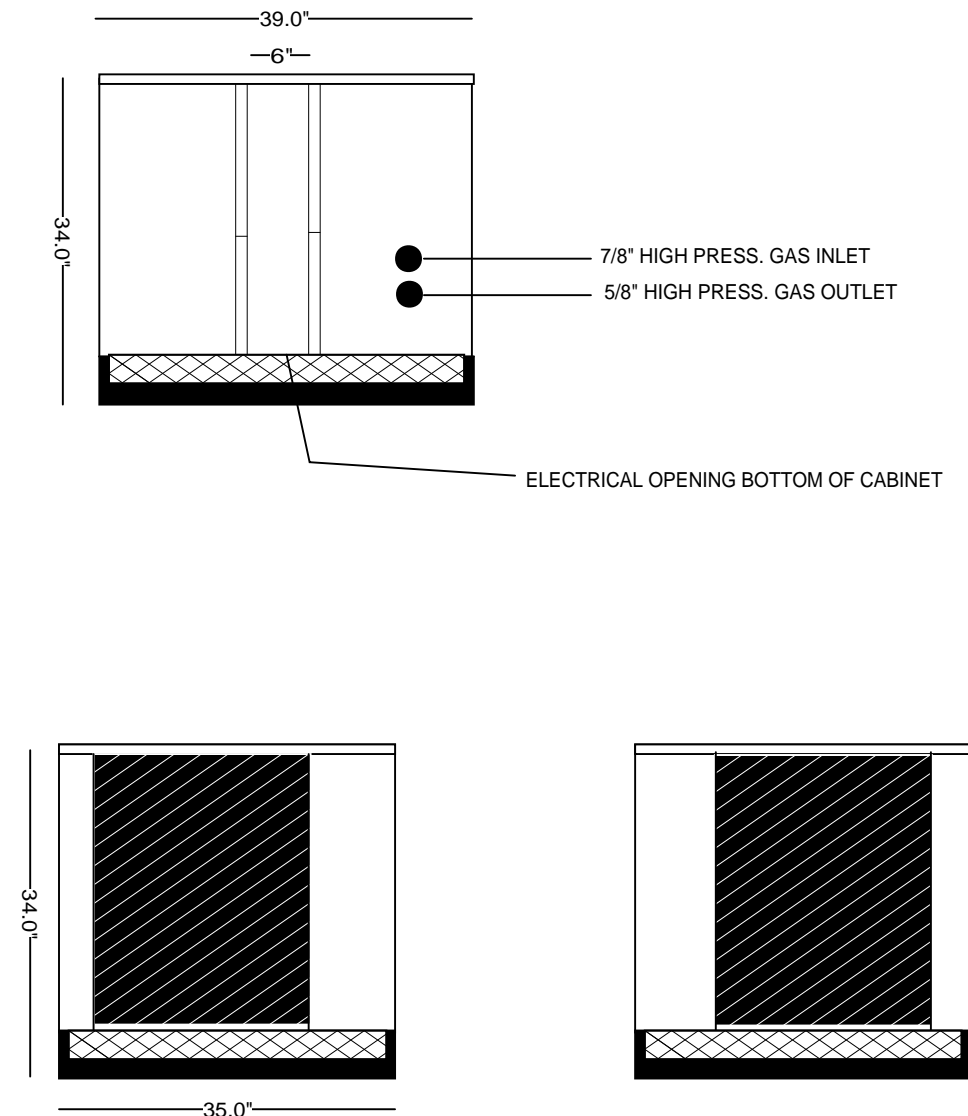

SPECIFICATIONS:

- 72,000 BTU/HR heat removal - 95F degree ambient, 45F degree water out.
- Electrical: 208-230 / 60/ 3Ph., 24 volt electrical panel.
- Run Load 30.7 Amps.
- Minimum Circuit Ampacity: 36; Maximum Circuit Ampacity: 65.
- ETL/CSA Laboratory Approved: ETL # 63122 & CANCSA NO. 236.
- 40 gallon, 16 gage, 304 stainless steel closed evaporator tank with coil inside.
- 1 HP water pump: 25-30 GPM, 30-35 PSI.
- Low ambient start-up package (standard).
- R422D Refrigerant.
- Analog water temperature and pressure gauges.
- Air-cooled condenser.
- Cabinet: 18 and 20 GA Phos coat galvanized steel finished with polyester powder coat.
- Base frame: 1/8 inch angle and channel iron.
- Compressor: Copeland Scroll (5 year warranty).
- Approximate crated weight: 875 LBS.
- Condenser dimensions: 39" wide X 35" deep X 34" tall.
- Evaporator dimensions: 39" wide X 35" deep X 47" tall.

NOT TO SCALE